



**Barningham Street**

Darlington DL3 6NS

**£75,000**







This footer paragraph is an example only and should not be relied upon as complying with current legislation. These particulars, whilst believed to be accurate are set out as a general outline only for guidance and do not constitute any part of an offer or contract. Intending purchasers should not rely on them as statements of representation of fact, but must satisfy themselves by inspection or otherwise as to their accuracy. No person in this firms employment has the authority to make or give any representation or warranty in respect of the property.



[www.venturepropertiesuk.com](http://www.venturepropertiesuk.com)

# Barningham Street

Darlington DL3 6NS



- Two Bedrooms
- Gas Central Heating
- Close to Hospital

- Modern Bathroom
- Double Glazing
- Walking Distance to Town Centre

- Modern Kitchen
- Council Tax Band A
- EPC Rating D

Well presented, two bedroom, mid terrace property situated in the Denes location of Darlington. The property is close to local amenities, short walk into the Town Centre, as well as close to local parks and Darlington Memorial Hospital. The property in brief: Entrance Vestibule, Lounge, Kitchen/Diner, Two Bedrooms, Bathroom and Rear Yard. Viewing is highly recommended.

## Entrance Vestibule

Wooden storm front door, leading to.

## Lounge

13'0" x 13'0" (3.974 x 3.981)

Double glazed window, double radiator and storage cupboard.

## Kitchen/Diner

13'1" x 10'4" (3.994 x 3.174)

Tiled flooring, small but modern kitchen suite comprising of floor, wall and drawer units, contrasting work surfaces, stainless steel sink, part tiled walls, space for cooker, space for washer, double glazed window, radiator and part glazed back door.

## First Floor Landing

Leading to.

## Bedroom One

13'1" x 13'0" (3.989 x 3.979)

Double bedroom situated to the front of the property with built in wardrobes, double glazed window and double radiator.

## Bathroom

Vinyl flooring, fitted with a suite comprising of low level w/c, wash hand basin, panelled bath with over head electric shower and shower screen, part tiled walls, double glazed window and heated towel rail.

## Bedroom Two

10'4" x 6'4" (3.174 x 1.951)

Situated to the rear of the property with window and single radiator.

## Externally

Enclosed garden to the rear with outbuildings and gated access to rear lane

## Council Tax

Band A.

## Tenure

This property is freehold

## Note

IMPORTANT NOTE TO PURCHASERS: We endeavour to make our sales particulars accurate and reliable, however, they do not constitute or form part of an offer or any contract and none is to be relied upon as statements of representation or fact. The services, systems and appliances listed in this specification have not been tested by us and no guarantee as to their operating ability or efficiency is given. All measurements have been taken as a guide to prospective buyers only, and are not precise. Floor plans where included are not to scale and accuracy is not guaranteed. If you require clarification or further information on any points, please contact us, especially if you are travelling some distance to view. Fixtures and fittings other than those mentioned are to be agreed with the seller. We cannot also confirm at this stage of marketing the tenure of this house

## Photo's

The photo's used are from 2021

GROUND FLOOR

1ST FLOOR

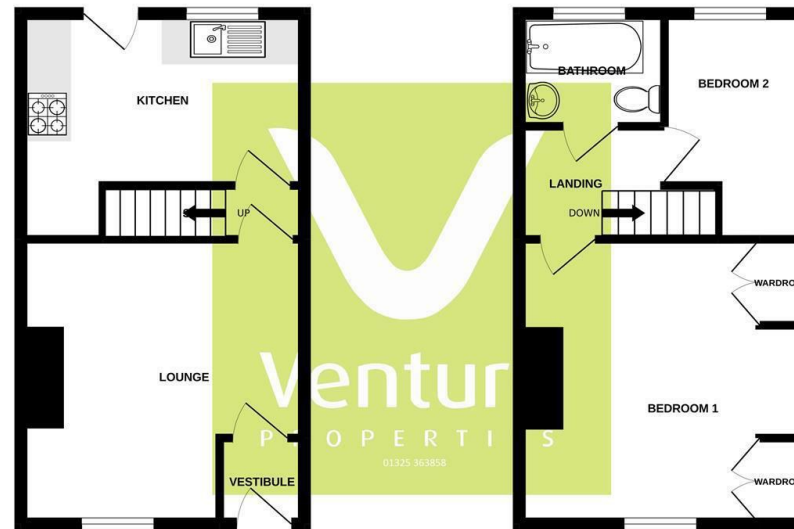

Whilst every attempt has been made to ensure the accuracy of the floorplan contained here, measurements of doors, windows, rooms and any other items are approximate and no responsibility is taken for any error, omission or mis-statement. This plan is for illustrative purposes only and should be used as such by any prospective purchaser. The services, systems and appliances shown have not been tested and no guarantee as to their operability or efficiency can be given.  
Made with Mergin ©2022

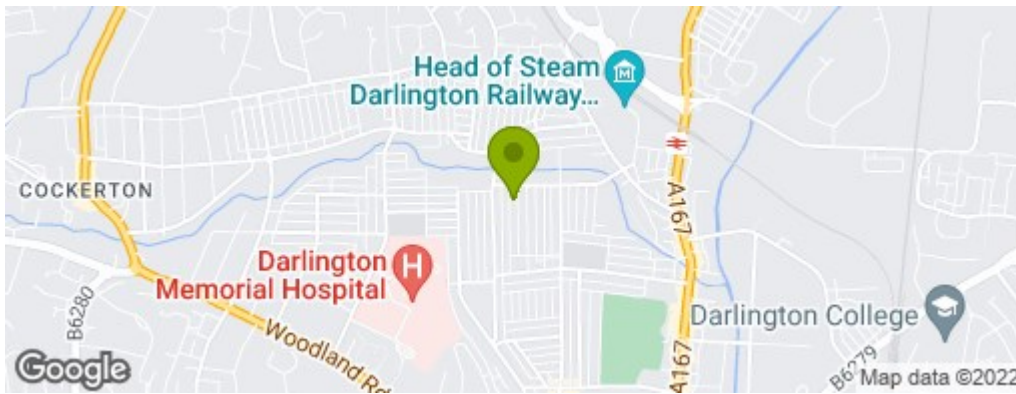

## Property Information

**01325 363858**

45 Duke Street, Darlington, County Durham, DL3 7SD  
sales@venturepropertiesuk.com